

**IE-C5DB4WE0040MCSMCS-E**

**Weidmüller Interface GmbH & Co. KG**  
Klingenbergstraße 26  
D-32758 Detmold  
Germany

www.weidmueller.com



Assembled IE cables, railway cable RW (reduced wire),  
Cat. 5, PUR, black, plug on both sides M12 straight pin

**General ordering data**

Version	System cable, M12 D-code – IP 67 straight pin, M12 D-code – IP 67 straight pin, Cat. 5e, Radox EM 104, 4 m
Order No.	<a href="#">3134070040</a>
Type	IE-C5DB4WE0040MCSMCS-E
GTIN (EAN)	4099987348638
Qty.	1 items

## IE-C5DB4WE0040MCSMCS-E

Weidmüller Interface GmbH &amp; Co. KG

Klingenbergstraße 26

D-32758 Detmold

Germany

www.weidmueller.com

## Technical data

## Dimensions and weights

Length	4 m	Length (inches)	157.4803 inch
Net weight	250 g		

## Temperatures

Storage temperature	Operating temperature	-25 °C...85 °C
---------------------	-----------------------	----------------

## Cable specific standards

Fluorine content	According to EN 60684-2 Section 45.2	Flames propagate vertically on bundled cables	in accordance with EN 50266, EN 50305, EN 60332-3-25, According to NF C32-070, 2.1, According to UL1685, 12 (FT4 exp.)
Multi-wire metallic data and control cable	According to EN50288-2-2	Hydrogen halide content	According to EN-50267-2-1
Corrosiveness of fumes	EN 50267-2-2	Fire safety for railway vehicles	According to BS 6853, GM/RT 2130, Ia,Ib, II, According to EN 45545, HL1 - HL3, According to DIN 5510 1-4, According to NF F16-101, A1, A2, B, According to UNI CEI 11170, LR1-LR4, NFPA 130
Impervious to smoke	According to BS 6853 Appendix D, According to IEC 61034-2, According to UL1685, 12 (FT4 exp.)	Poisonous gases	According to BS 6853 Appendix B

## General standards

Connector standard	IEC 61076-2-101
--------------------	-----------------

## Cable structure

Wire connection cross section AWG, max.	AWG 22	Sheathing colour	black
Cross-section	4*AWG 22/7 - 0.32 mm <sup>2</sup>	Shielding	SF/UTP
Number of wires	4	Insulation cross-section	1.55 mm
Insulation	PE	Sheath diameter, max.	7 mm
Sheath diameter, min.	6.2 mm	Material sheath	Radox EM 104
Colour coding	yellow, white, orange, blue	Wire material	Copper alloy

## Electrical properties of cable

Category	Cat. 5e
----------	---------

## Mechanical and material properties of cable

Resistance to oils	in accordance with EN 50264-1 or EN 50306-1	Halogen	No
Min. bending radius, repetitive	6 *diameter	Min. bending radius, once only	10 x cable diameter
Resistance to spread of flame	in accordance with IEC 60332-1-2, According to	Corrosiveness of fumes	EN 50267-2-2

## IE-C5DB4WE0040MCSMCS-E

**Weidmüller Interface GmbH & Co. KG**  
 Klingenbergstraße 26  
 D-32758 Detmold  
 Germany

[www.weidmueller.com](http://www.weidmueller.com)

## Technical data

	NF C32-070, 2.1, NFPA 130
Impervious to smoke	According to BS 6853 Appendix D, According to IEC 61034-2, According to UL1685, 12 (FT4 exp.)

### Plug, left

Plug left	connector, M12, D-coded, Number of poles: 4, IP67, male contact, straight, shielded
-----------	---

### Plug, right

Plug right	connector, M12, D-coded, Number of poles: 4, IP67, male contact, straight, shielded
------------	---

### Classifications

ETIM 8.0	EC002599	ETIM 9.0	EC002599
ETIM 10.0	EC002599	ECLASS 14.0	27-06-03-08
ECLASS 15.0	27-06-03-08		

**IE-C5DB4WE0040MCSMCS-E**

**Weidmüller Interface GmbH & Co. KG**  
 Klingenbergstraße 26  
 D-32758 Detmold  
 Germany

**Drawings**

www.weidmueller.com

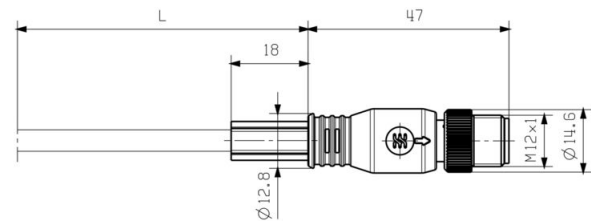
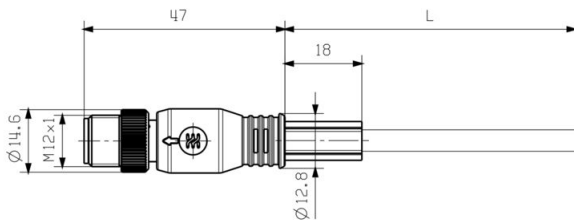

**Wiring diagram**

**Detailed drawing**

M12		M12
1	yellow	1
2	white	2
3	orange	3
4	blue	4

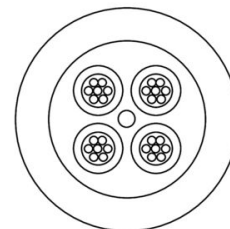

## IE-C5DB4WE0040MCSMCS-E

**Weidmüller Interface GmbH & Co. KG**  
 Klingenbergstraße 26  
 D-32758 Detmold  
 Germany

www.weidmueller.com

## Accessories

## Screwty® cable gland tool



The ideal tool for any application  
 Screwty® is the ideal, all-purpose tool for tightening all common sensor and actuator cables. Even difficult-to-reach round plugs are accessible using the Screwty®. A simple turning movement tightens and loosens the connectors without the need for excessive force. The Screwty® is a unique and global solution since it fits with most cables and plugs from other vendors (over 90 %). The Screwty® consists of a handle with a conventional 1/4" adapter. Thus it can be used for all sizes: for M12 and M8 round plug-in connectors, and for M12F and M8F customisable plugs and sockets, as well as for all M23 plugs and sockets.

## General ordering data

Type	SCREWTY SET	Version	
Order No.	<a href="#">1910000000</a>		Cable gland tool for M8, M12 lines and connectors
GTIN (EAN)	4032248436842		
Qty.	1 ST		

## Screwty® cable gland tool with torque function



The ideal tool for any application  
 Screwty® is the ideal, all-purpose tool for tightening all common sensor and actuator cables. Even difficult-to-reach round plugs are accessible using the Screwty®. A simple turning movement tightens and loosens the connectors without the need for excessive force. The Screwty® is a unique and global solution since it fits with most cables and plugs from other vendors (over 90 %). The Screwty® consists of a handle with a conventional 1/4" adapter. Thus it can be used for all sizes: for M12 and M8 round plug-in connectors, and for M12F and M8F customisable plugs and sockets, as well as for all M23 plugs and sockets.

## General ordering data

Type	SCREWTY SET -DM	Version	
Order No.	<a href="#">1920000000</a>		Cable gland tool for M8, M12 lines and connectors
GTIN (EAN)	4032248436859		
Qty.	1 ST		

## IE-C5DB4WE0040MCSMCS-E

**Weidmüller Interface GmbH & Co. KG**  
 Klingenbergstraße 26  
 D-32758 Detmold  
 Germany

www.weidmueller.com

## Accessories

## Screwty® cable gland tool



The ideal tool for any application  
 Screwty® is the ideal, all-purpose tool for tightening all common sensor and actuator cables. Even difficult-to-reach round plugs are accessible using the Screwty®. A simple turning movement tightens and loosens the connectors without the need for excessive force. The Screwty® is a unique and global solution since it fits with most cables and plugs from other vendors (over 90 %). The Screwty® consists of a handle with a conventional 1/4" adapter. Thus it can be used for all sizes: for M12 and M8 round plug-in connectors, and for M12F and M8F customisable plugs and sockets, as well as for all M23 plugs and sockets.

## General ordering data

Type	SCREWTY- M12	Version	
Order No.	<a href="#">1900000000</a>		Cable gland tool for moulded M12 lines
GTIN (EAN)	4032248375868		
Qty.	1 ST		

## Screwty® cable gland tool with torque function



The ideal tool for any application  
 Screwty® is the ideal, all-purpose tool for tightening all common sensor and actuator cables. Even difficult-to-reach round plugs are accessible using the Screwty®. A simple turning movement tightens and loosens the connectors without the need for excessive force. The Screwty® is a unique and global solution since it fits with most cables and plugs from other vendors (over 90 %). The Screwty® consists of a handle with a conventional 1/4" adapter. Thus it can be used for all sizes: for M12 and M8 round plug-in connectors, and for M12F and M8F customisable plugs and sockets, as well as for all M23 plugs and sockets.

## General ordering data

Type	SCREWTY-M12-DM	Version	
Order No.	<a href="#">1900001000</a>		Cable gland tool for moulded M12 lines
GTIN (EAN)	4032248436408		
Qty.	1 ST		