

AP PPT/35

Weidmüller Interface GmbH & Co. KG

Klingenbergstraße 26
D-32758 Detmold
Germany

www.weidmueller.com

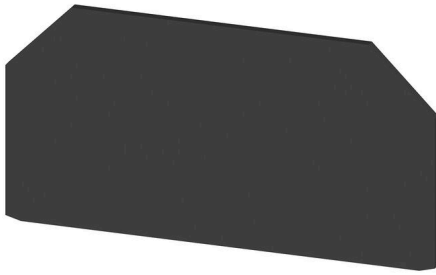

Partition plates and end plates are essential accessories for terminal blocks. Partition plates provide optical and electrical separation of different potentials and functional groups, increasing safety and ensuring a clear structure inside the control cabinet. End plates close the terminal block row on the sides, protect against contact with live parts, and ensure a clean, stable finish. Both components are precisely matched to the respective Weidmüller terminal block series, contributing to safe, compliant, and professional wiring.

General ordering data

Version	End plate for terminals, Anthracite, Height: 138 mm, Width: 3 mm, V-2, Snap-on: Yes
Order No.	3835 120000
Type	AP PPT/35
GTIN (EAN)	4008 190003364
Qty.	10 items

AP PPT/35

Weidmüller Interface GmbH & Co. KG
 Klingenbergstraße 26
 D-32758 Detmold
 Germany

www.weidmueller.com

Technical data

Approvals

ROHS	Conform
------	---------

Dimensions and weights

Depth	71.15 mm	Depth (inches)	2.8012 inch
Height	138 mm	Height (inches)	5.4331 inch
Width	3 mm	Width (inches)	0.1181 inch
Net weight	49.37 g		

Temperatures

Storage temperature	-25 °C...55 °C	Ambient temperature	-50 °C...55 °C
Continuous operating temp., min.	-50 °C	Continuous operating temp., max.	100 °C

Environmental Product Compliance

RoHS Compliance Status	Compliant without exemption
REACH SVHC	No SVHC above 0.1 wt%

Material data

Colour	Anthracite	UL 94 flammability rating	V-2
--------	------------	---------------------------	-----

System specifications

Version	End plate
---------	-----------

Additional technical data

Snap-on	Yes	Installation advice	Direct mounting
---------	-----	---------------------	-----------------

General

Installation advice	Direct mounting
---------------------	-----------------

Classifications

ETIM 8.0	EC000886	ETIM 9.0	EC000886
ETIM 10.0	EC000886	ECLASS 14.0	27-25-03-01
ECLASS 15.0	27-25-03-01		